



WAREMA International GmbH  
 Hans-Wilhelm-Renkhoff-Str. 2  
 97828 Marktheidenfeld • Germany  
 Fax: +49 9391 20-3899  
 www.warema.com · orders@warema.com

The General Terms and Conditions of the WAREMA company responsible for you apply. The [General Terms and Conditions](#) can be viewed on the Internet and downloaded from there. The order is based on these General Terms and Conditions in the contract.

Our products are custom-made items and therefore cannot be exchanged or returned.



**Attention!**  
 Repeat  
 (E-mail/fax)

					Different delivery address, contact and telephone	Project order number
Customer no.	Order date	Orderer	Delivery date	Offer number		

Customer name: \_\_\_\_\_

Reference: \_\_\_\_\_

Notes	
-------	--

## Order form for Perea P70 pergola awnings

The current technical data apply. Order data: all specifications are in the extension direction. All dimensions are order dimensions in mm.

If no dimensions are entered, the standard model will be used. Order width = outer edge of rafter to outer edge of rafter. The complete awning (incl. side covers) is 62 mm wider.

**Note:** In case of an on-site gradient, please provide a sketch.

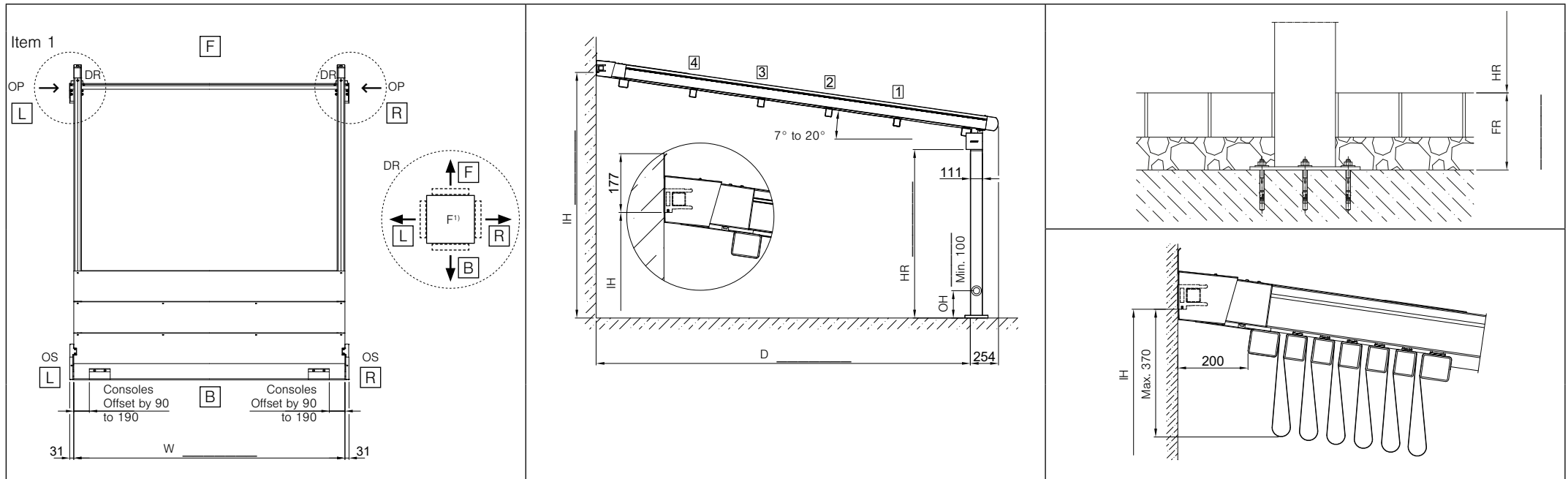

Legend		Legend		Legend	
W	Order width	OS	Operation side	L	Left
D	Order depth	OP	Outlet position	R	Right
IH	Installation height	DR	Drainage, outlet direction	F	Front
HR	Headroom	OH	Outlet height	B	Rear
FR	Floor recess			F <sup>1)</sup>	Floor

<sup>1)</sup> Drainage through the base plate into the ground is only possible with the pole for large concrete foundations (see page 2, concrete foundation).

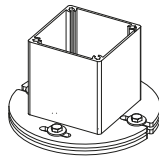
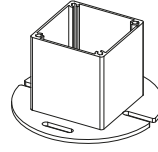
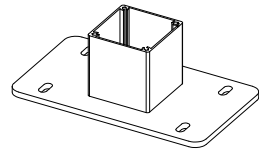
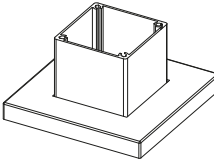
<p><b>Drive</b></p> <input type="checkbox"/> Motor (standard) <input type="checkbox"/> WMS Plug receiver <input type="checkbox"/> WMS Hand-held transmitter basic <input type="checkbox"/> WMS Hand-held transmitter plus (6-ch.) <input type="checkbox"/> WMS Hand-held transmitter comfort	<p><b>Pole fixing</b></p> <input type="checkbox"/> <b>Ground screw</b> _____ piece(s), Krinner ground screw _____ piece(s), adapter plates incl. fixing material  <input type="checkbox"/> <b>Concrete foundation</b> <input type="checkbox"/> Pole for concrete foundation, small (standard) <input type="checkbox"/> Pole for concrete foundation, large (optional) <sup>2)</sup>   <input type="checkbox"/> <b>Base cover</b> (optional) 	<p><b>Colour specifications</b></p> <p><b>Frame colour</b> _____ <b>Fabric</b> Design<sup>5)</sup> _____                  Colour number _____                  Fine texture surface _____                  Other _____                  Note: We recommend the fine texture surface quality as it is resistant to external influences (dirt, scratches, etc.).</p> <p><b>Accessories</b></p> <p><b>Light</b>                  _____ piece(s) LED strip light rail (max. 6 pieces)                  Transverse profile no.    9   8   7   6   5   4   3   2   1                  LED position                    <input type="checkbox"/> <input type="checkbox"/> <input type="checkbox"/> <input type="checkbox"/> <input type="checkbox"/> <input type="checkbox"/> <input type="checkbox"/> <input type="checkbox"/> <input type="checkbox"/>  <input type="checkbox"/> WMS Dimmer (LED)</p> <p><b>Radiant heater</b>                  _____ piece(s) Basic radiant heater                  Colour (satin finish surface):  <input type="checkbox"/> RAL 9016    <input type="checkbox"/> RAL 9006    <input type="checkbox"/> RAL 9005  <input type="checkbox"/> WMS Plug receiver power                  _____ piece(s) Design radiant heater                  Colour number                    _____                  Surface<sup>4)</sup>                            _____  <input type="checkbox"/> WMS Plug receiver power</p> <p><i>Accessories continued on next page</i></p>																								
<p><b>Console type/substructure</b></p> <input type="checkbox"/> Wall <input type="checkbox"/> Concrete <input type="checkbox"/> Solid brick <input type="checkbox"/> Wood <input type="checkbox"/> Other _____ <input type="checkbox"/> Fixing material <sup>1)</sup> _____	<p><b>Number of transverse profiles</b></p> <table border="1" style="width:100%; border-collapse: collapse;"> <thead> <tr> <th style="width:33%;">Order depth for 7° inclination</th> <th style="width:33%;">Quantity Transverse profile</th> <th style="width:33%;">Max. no. of additional transverse profiles</th> </tr> </thead> <tbody> <tr><td>2000 - 2213</td><td>2</td><td>1</td></tr> <tr><td>2214 - 2863</td><td>3</td><td>2</td></tr> <tr><td>2864 - 3513</td><td>4</td><td>2</td></tr> <tr><td>3514 - 4163</td><td>5</td><td>2</td></tr> <tr><td>4164 - 4813</td><td>6</td><td>2</td></tr> <tr><td>4814 - 5463</td><td>7</td><td>3</td></tr> <tr><td>5464 - 6000</td><td>8</td><td>4</td></tr> </tbody> </table>	Order depth for 7° inclination	Quantity Transverse profile	Max. no. of additional transverse profiles	2000 - 2213	2	1	2214 - 2863	3	2	2864 - 3513	4	2	3514 - 4163	5	2	4164 - 4813	6	2	4814 - 5463	7	3	5464 - 6000	8	4	<p><b>Additional transverse profiles</b></p> <input type="checkbox"/> Additional transverse profile _____ piece(s)
Order depth for 7° inclination	Quantity Transverse profile	Max. no. of additional transverse profiles																								
2000 - 2213	2	1																								
2214 - 2863	3	2																								
2864 - 3513	4	2																								
3514 - 4163	5	2																								
4164 - 4813	6	2																								
4814 - 5463	7	3																								
5464 - 6000	8	4																								
	<p><b>Fixing material</b></p> <input type="checkbox"/> None <input type="checkbox"/> Concrete foundation <input type="checkbox"/> Spacer (threaded rods) <p><b>Multicube set</b></p> <input type="checkbox"/> Grey <input type="checkbox"/> Anthracite <input type="checkbox"/> Dark brown																									

<sup>1)</sup> Standard fixing materials for selected substructure without spacing to the load-bearing substructure.

<sup>2)</sup> A large concrete foundation is required if glazing is to be installed on-site.

<sup>4)</sup> If no information is provided about the surface, the standard defined as per the WAREMA Colour World will be supplied.

<sup>5)</sup> Only Soltis W96 can be used here.

Accessories <i>continued</i>	Drive	Accessories <i>continued</i>
<p><b>Front-mounted awnings with easyZIP guidance FRONT</b></p> <p>- As viewed in the extension direction - Attached between the poles</p> <p><input type="checkbox"/> Mains power connection for front-mounted awnings with easyZIP guidance, front</p> <p>Only one line is routed through the main unit for the front-mounted awning with easyZIP guidance, front. The line is routed on the connection side of the Perea P70. For series-mounted units, the line is routed to the front on the outside through the guide rail.</p> <p>By entering the data for the Perea P70, the following features for front-mounted awnings with easyZIP guidance, front, are predefined and specified in the standard:</p> <ul style="list-style-type: none"> <li>- Individual unit</li> <li>- Order width = pole distance</li> <li>- Order height = Headroom - 11 mm (for base plate) = Headroom - 30 mm (for base cover)</li> <li>- Size 15 cover panel</li> <li>- Deep guide rails, 26 x 110 mm</li> <li>- Operation side = P70 drainage side</li> <li>- Cable exit = top front (free cable end, 1.2 m long, without STAS)</li> <li>- Right rolling blind</li> <li>- Reveal installation</li> <li>- Installation on aluminium</li> <li>- Incl. fixing material</li> </ul>	<p><input type="checkbox"/> Motor <input type="checkbox"/> WMS Radio motor<sup>6)</sup></p> <p>_____ piece(s) WMS Hand-held transmitter basic _____ piece(s) WMS Hand-held transmitter plus (6-ch) _____ piece(s) WMS Hand-held transmitter comfort</p> <p><b>Awning</b> (please note the processing notes in the technical data)</p> <p>Design _____ Outside<sup>7)</sup> _____</p> <p><b>Fabric connection</b> (selectable for all acrylic qualities)</p> <p><input type="checkbox"/> Sew (standard) <input type="checkbox"/> UltraSeam™ (surcharge)</p> <p><b>Colour specifications</b></p> <p>F-FM, V-FM (cover panel, drop profile, guide rails and brackets)</p> <p>Colour number _____</p> <p>Surface<sup>8)</sup> _____</p> <p>Special colour/anodisation _____</p> <p><b>Drop profile</b></p> <p><input type="checkbox"/> With brush seal</p>	<p><b>Front-mounted awnings with easyZIP guidance, LEFT and RIGHT</b></p> <p>We recommend ordering front-mounted awnings with easyZIP guidance on the left and right sides only after the main unit has been installed.</p> <p>Measurement inaccuracies can result in front-mounted awnings that do not fit. The operation side is on the house wall side in each case. We recommend a right-rolling blind with a size 15 cover panel. When attaching front-mounted awnings with easyZIP guidance on the left and right sides, the cable exit is on the facade.</p> <p><sup>6)</sup> WMS Hand-held transmitters can be programmed to the WMS Radio motor at the factory. Please note any details regarding this position separately. <sup>7)</sup> Indicate the outside colour for two-colour designs. If no specifications are made, the standard defined in the WAREMA collection will be supplied. <sup>8)</sup> If no specifications regarding the surface are made, the standard defined in the WAREMA Colour World overview will be supplied.</p>
<p><b>Notes</b></p>	<p><b>Sketches</b></p>	